

## 1. Product picture

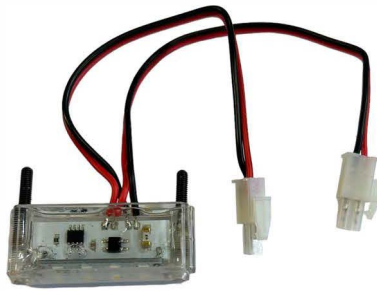

## 2. Product description

2.1. Product Name	FerroxLED light
2.2. Product Model No.	FX100
2.3. Warranty	3 year

## 3. Electronic parameters

3.1. Rated voltage (V)	DC24V (SELV)
3.2. Rated power (W)	0.48W ± 10%

## 4. General parameters LED

4.1. LED type / size	SMD 2835	
4.2. Single LED current (mA)	30 mA ± 5%	
4.3. LED series/parallel mode	1S1P	
4.4. Power for LED Module (W)	0.5W ± 10%	
4.5. LED brand	Bridgelux	
<b>Photoelectric parameters</b>		
4.6. Luminous flux (lm) (Ta=25°C free burning after 60min)	28 lm ± 10%	
4.7. Optical efficiency (lm/W)	≥ 55 lm /W	
4.8. Color Temperature and tolerance	<input type="checkbox"/> IEC <input type="checkbox"/> ANSI 4000K	3465 ± 245K
4.9. Color rendering index	≥ 80	

Conditions of using			
4.10. Indoor / Outdoor use	<input checked="" type="checkbox"/> Indoor	<input checked="" type="checkbox"/> Outdoor	
4.11. IP grade	IP67		
4.12. UV Protective?	<input checked="" type="checkbox"/> Yes	<input type="checkbox"/> No	
4.13. Used in humid environment	<input checked="" type="checkbox"/> Yes	<input type="checkbox"/> No	
4.14. Operating temperature range	Min	Typ	Max
	-20°C	25°C	40°C

5. Data	
6.1 EAN code	7350146310000
6.2 Packaging size	4 pack
6.3 Carton size	392X392X370mm
6.4 Net/Gross weight	0,1g

**6. Mechanical parameters**

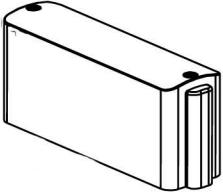
Sketch 	5.1. Dimension standard	$\emptyset 17 \pm 0.5 * 24 \pm 0.5 \text{mm}$
	5.2. Weight (g)	$6 \pm 1 \text{g}$
	5.3. Housing color	Opal
	5.4. Housing material	PC f1;

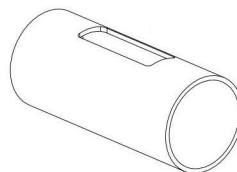
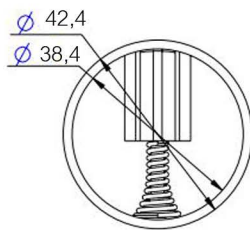
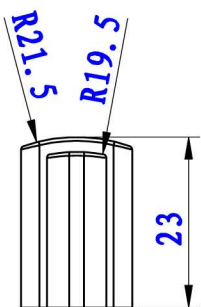
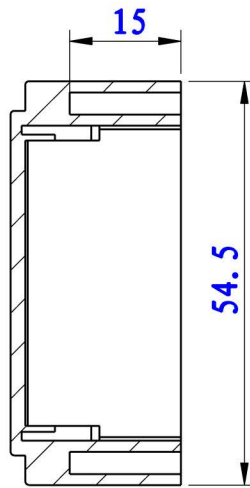
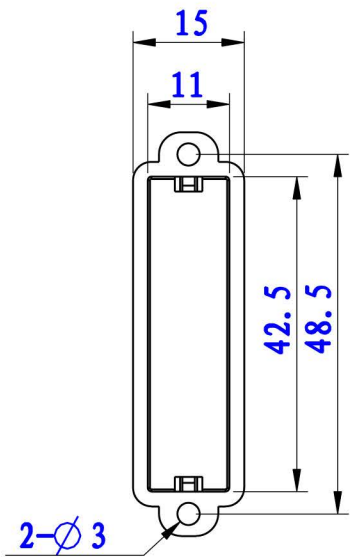

Milling / cut out in tube

